

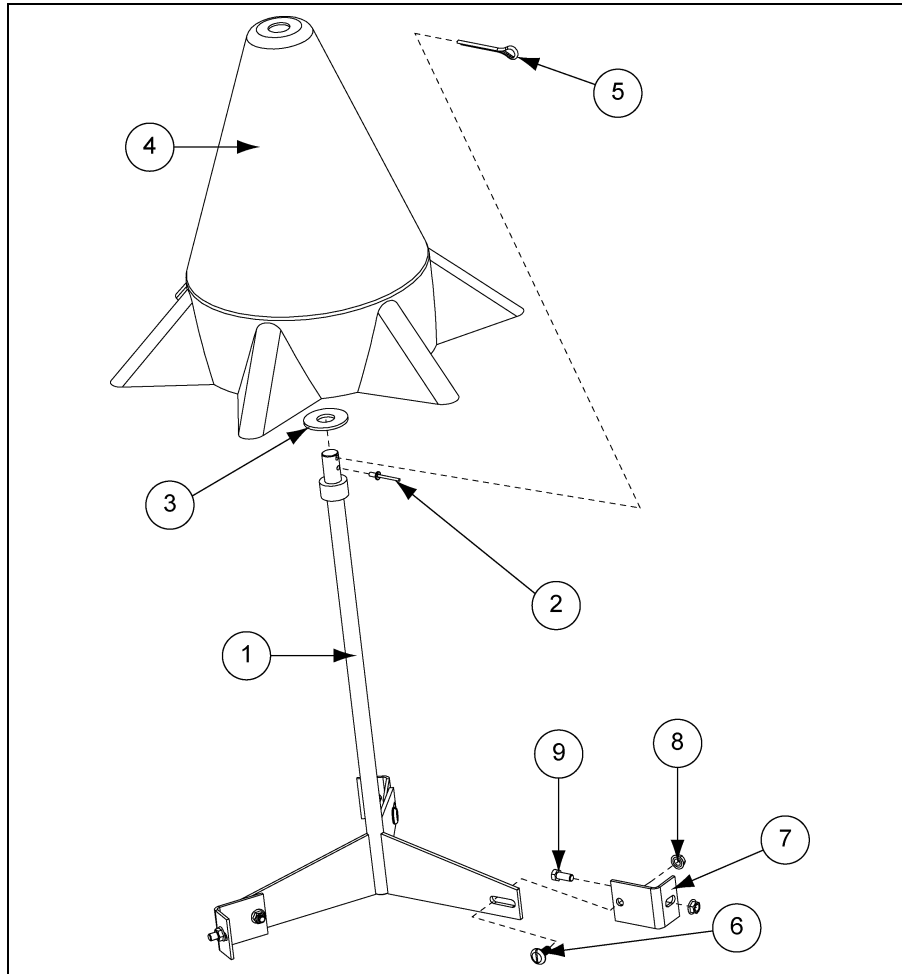

# Sure-Flo Installation Procedure

1004 East Illinois Street • Assumption, IL 62510 • 1-217-226-4421

The bin must be empty before installing the Sure-Flo into the hopper. Disconnect power to all unloading equipment that is connected to the bin. Remove the unloader and transfer plate and boot from the hopper collar.



Ref #	Part #	Description	Qty
1	FLX-4860	Agitator Support Hopper Assembly for 16"	1
1	FLX-5037	Agitator Support Hopper Assembly for 22"	1
2	S-7235	Rivet PMG 3/16" Diameter x 0.440" Long ARSM 0.063-0.250 Grip Range	1
3	S-866	Flat Washer 3/4" USS ZN Grade 2	1
4	FLX-4853	Sure-Flo Cone	1
5	S-6994	Cotter Pin 3/16" x 2" ZN Grade 2	1
6	S-4303	Bolt, Truss 5/16"-18 x 3/4" YDP Grade 8 or 8.2 with Nib Black Rubber Washer	3
7	FLX-4858	Agitator Support Angle	3
8	S-3611	Flange Nut 5/16"-18 YDP Grade 2	6
9	S-4275	Bolt, HHTB 5/16"-18 x 3/4" ZN Grade 5	3
NA	FLX-4854	Sure-Flo Assembly for 16" Collars	NA
NA	FLX-5035	Sure-Flo Assembly for 22" Collars	NA

Date: 07-19-12

Printed in the U.S.A.  
Copyright © 2012 by GSI Group  
www.gsiag.com



PNEG-1446

Page 1 of 2

CN-300943

# Sure-Flo Installation Procedure

---

## Installation of Mounting Angles

1. Remove three (3) bolts from the connection of the hopper panel and the hopper collar. For 16" collars with 24 bolts, remove every 8<sup>th</sup> bolt. For 16" collars with 18 bolts, remove every 6<sup>th</sup> bolt. For 22" collars with 36 bolts, remove every 12<sup>th</sup> bolt.
2. Install all mounting brackets on the inside of the bin. All brackets must face in the same direction. Only tighten finger tight at this time.

## Installation of Cone Support Assembly

1. Lift the cone support assembly up through the hopper collar and bolt to the mounting angles with the bolts provided.
2. Adjust assembly so that it is centered in the opening. At this time tighten all bolts.

## Installation of Sure-Flo Cone

1. Insert one end of a rope through the small hole in the top of the cone and feed it through the large hole at the bottom.
2. Tie a wrench or a large bolt to the end of the rope.
3. Lower the cone assembly through the bin lid and down over the cone support rod.
4. Reach up into the cone from underneath and pull the rope down and untie the object. Pull the rope out of the bin.
5. Reach up and position the cone so that it sits on the flat washer on the support assembly rod.
6. If the assembly is installed during the construction of a new bin, a cotter pin is provided to be installed in the hole at the end of the support shaft to keep the cone in place during the installation and transport of the bin.
7. Re-install the unloading equipment and fill bin.